

Cuyuna Engines

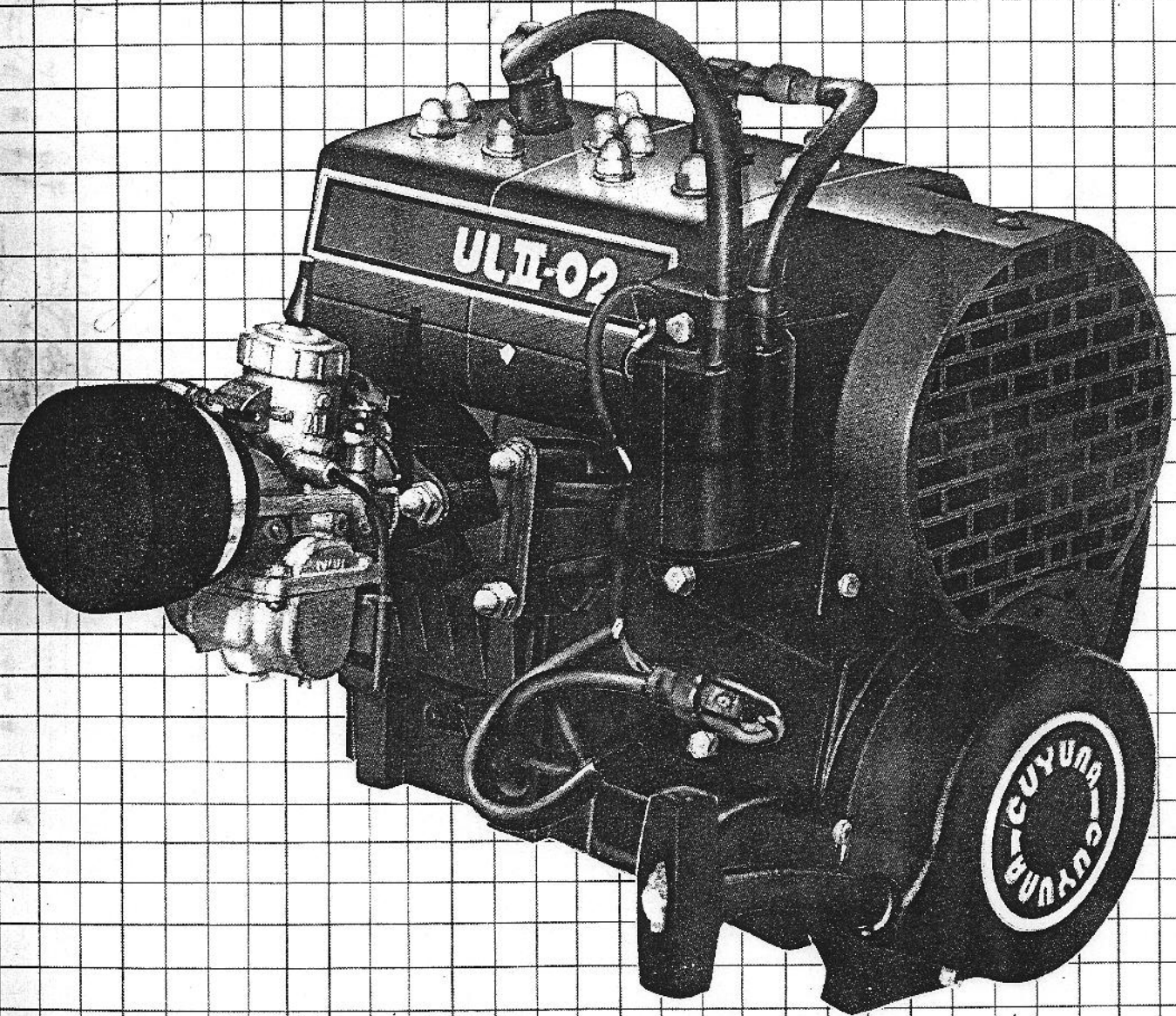

PARTS MANUAL

CUYUNA ENGINE

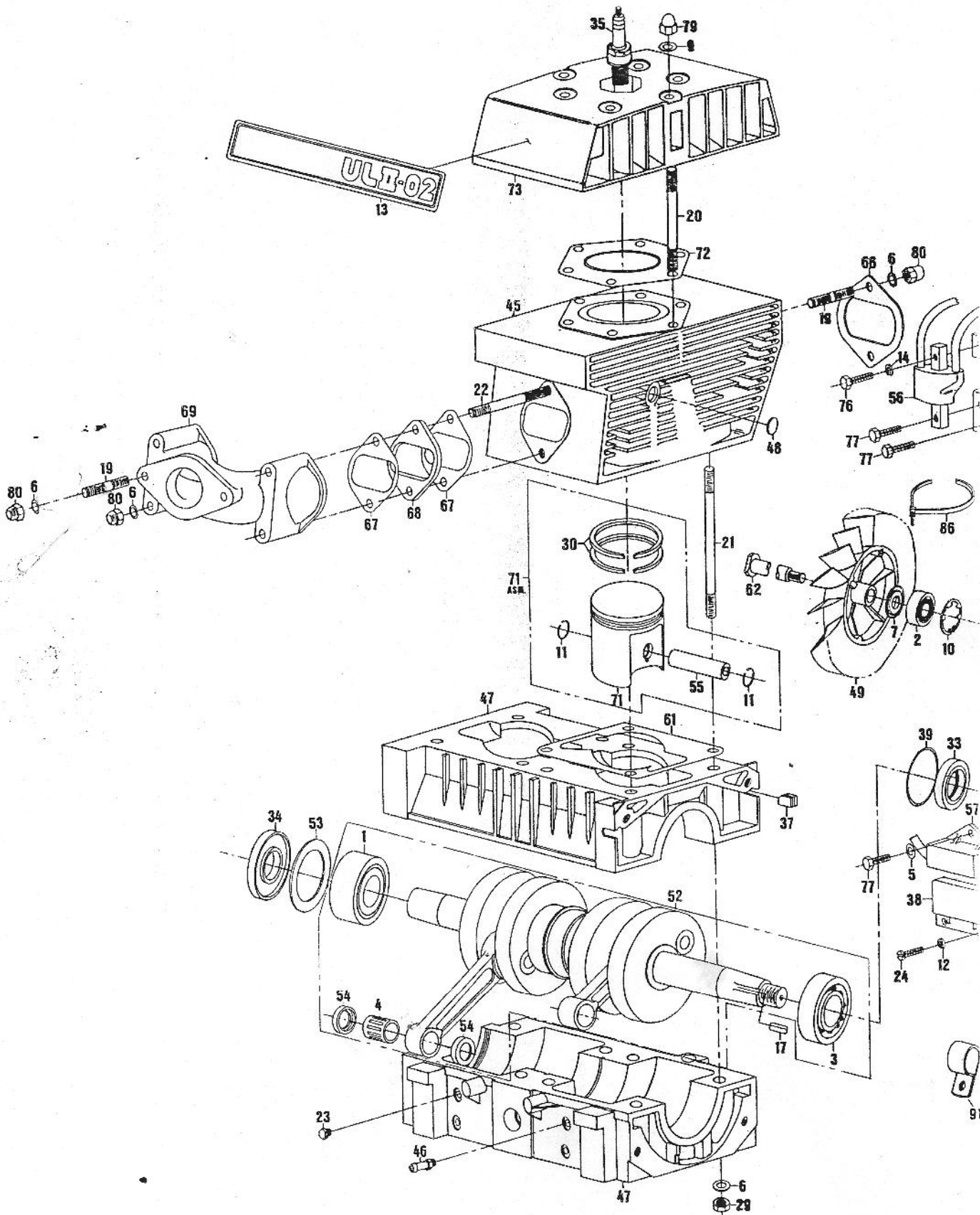

EXPLODED VIEW

NOTE: REFERENCE NUMBERS PERTAIN
215, 340, 430 AND U11-02 ENGINES.
(CHECK PARTS LISTING FOR CORRECT
PART NUMBERS.)

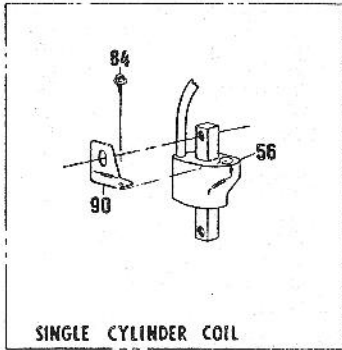

SINGLE CYLINDER COIL

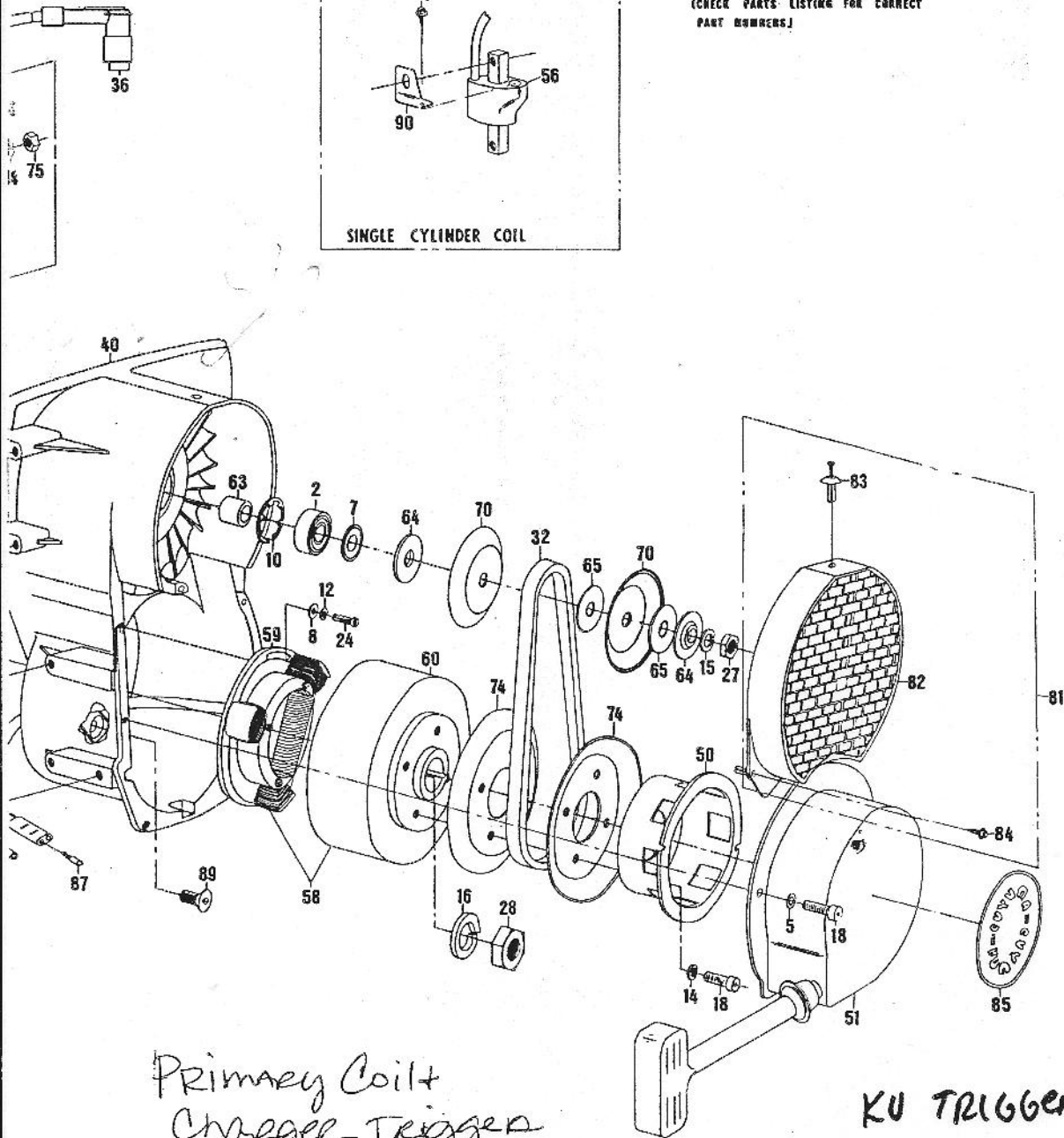

Primary Coil +
Charger Trigger
Coil

KU TRIGGER COIL

000-43-922-000

ELECTRIC START

106 ELECTRIC START KIT

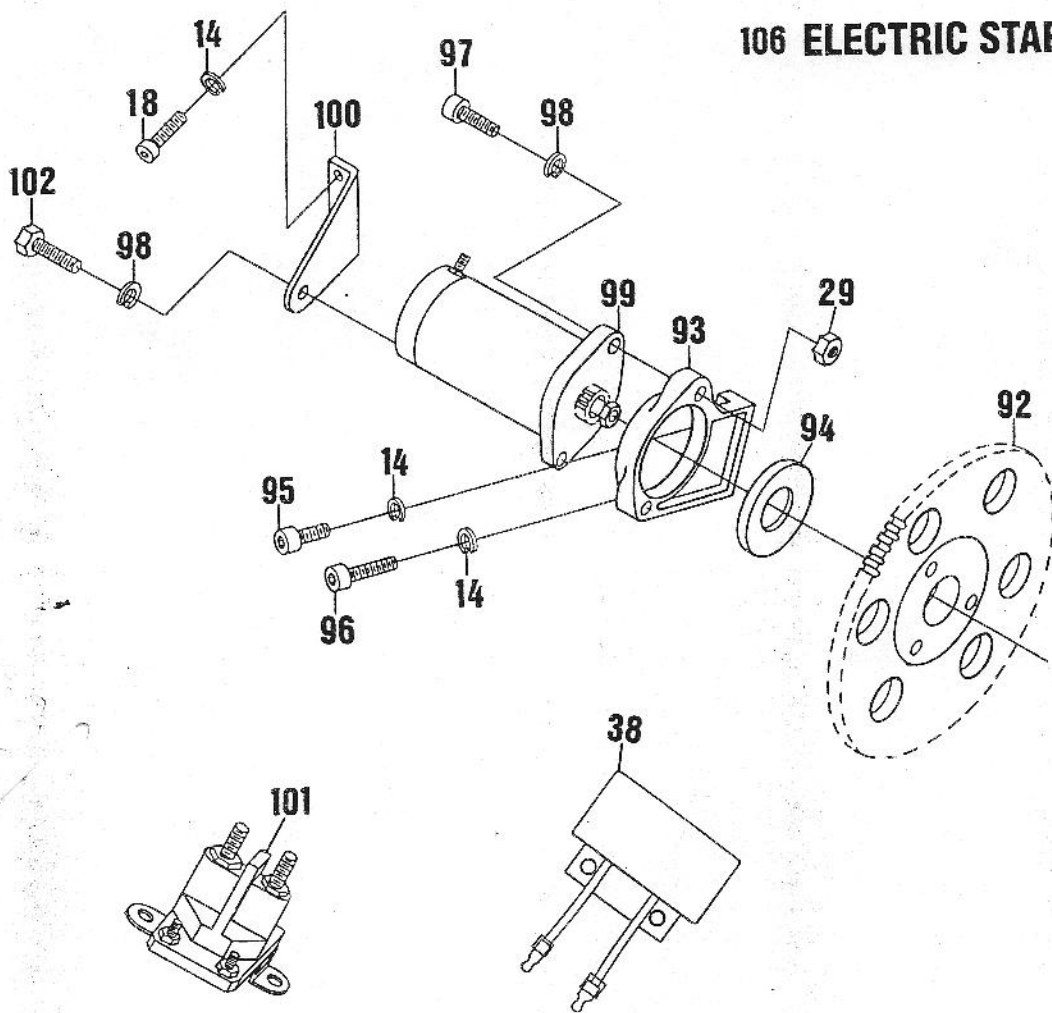

RECOIL STARTER (NSI)

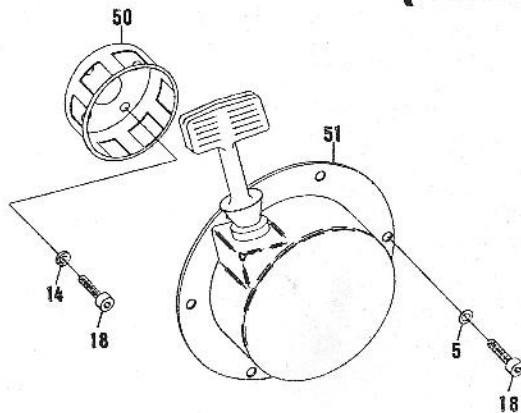

EXHAUST

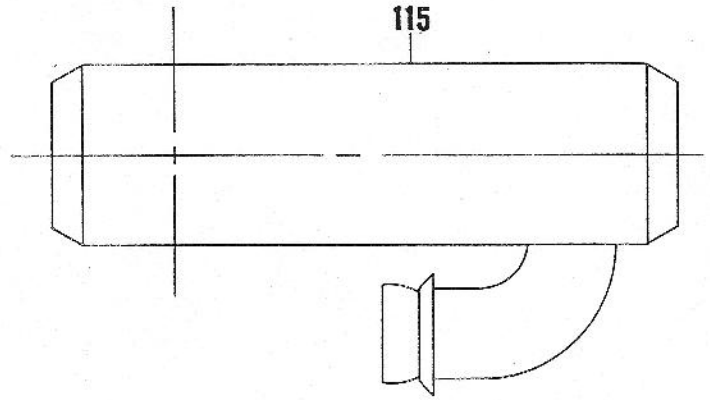
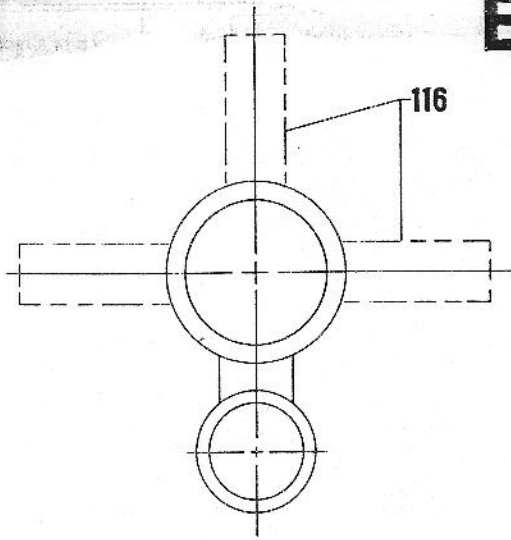

TWIN EXHAUST

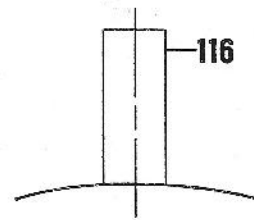
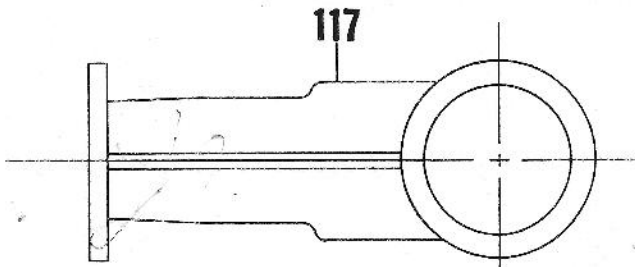

SINGLE EXHAUST

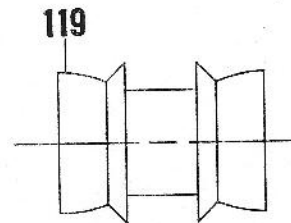
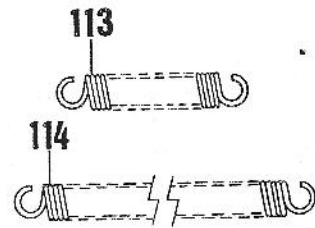
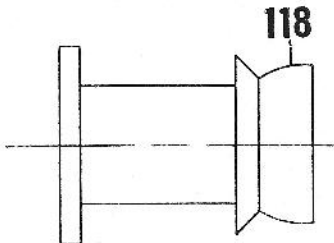
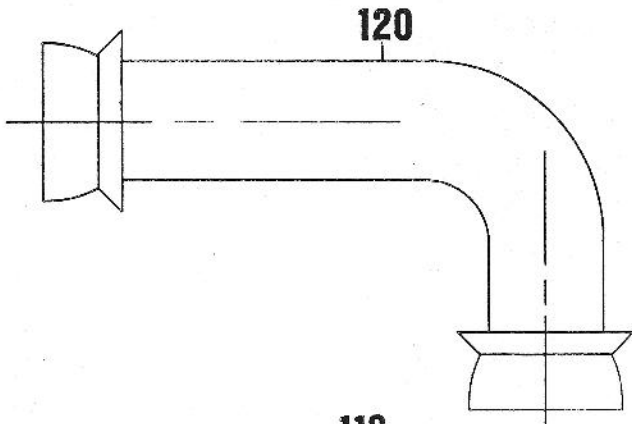

MUFFLER MOUNT

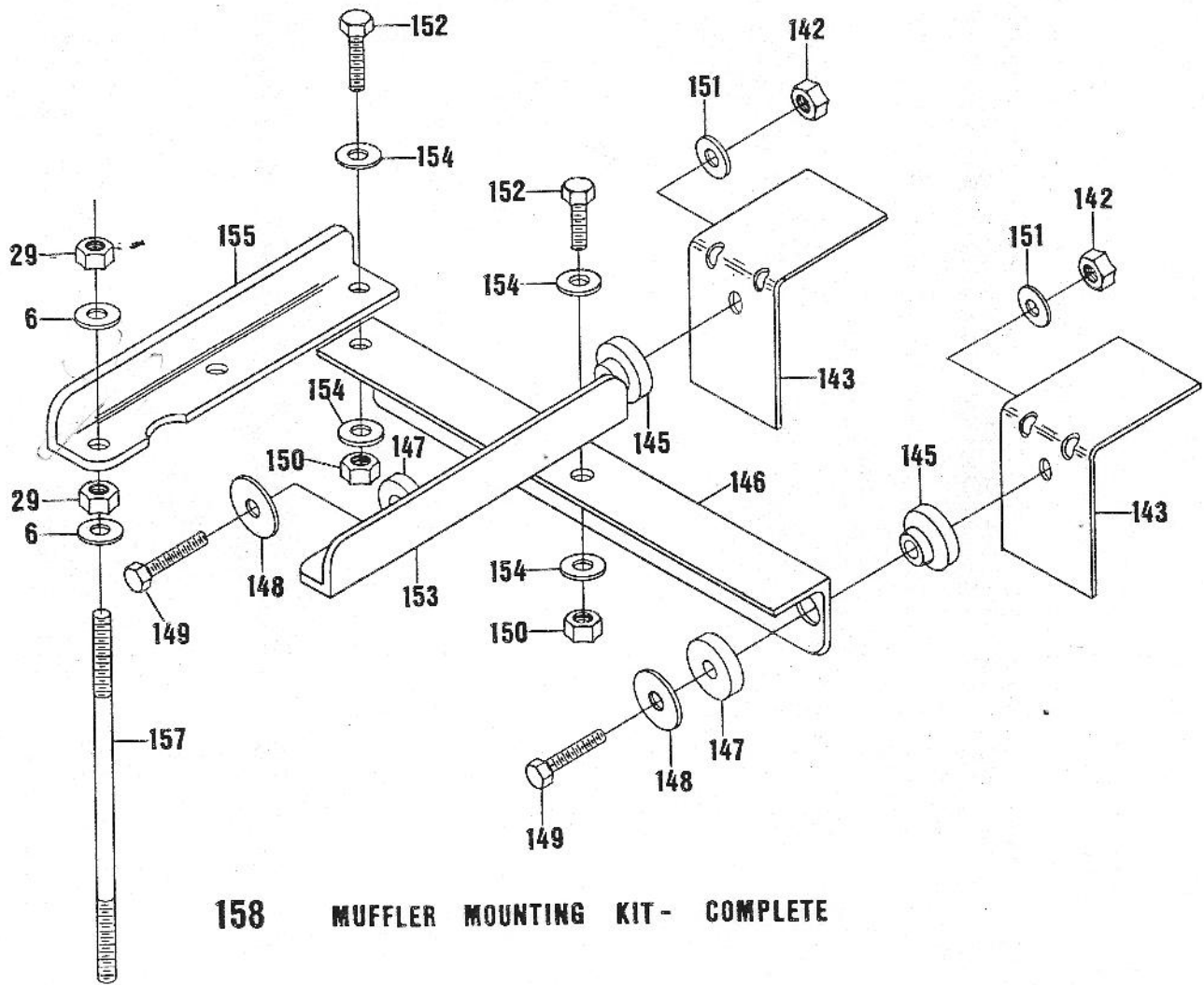

158 MUFFLER MOUNTING KIT - COMPLETE

215 STANDARD EXHAUST KIT

KIT NO. 165

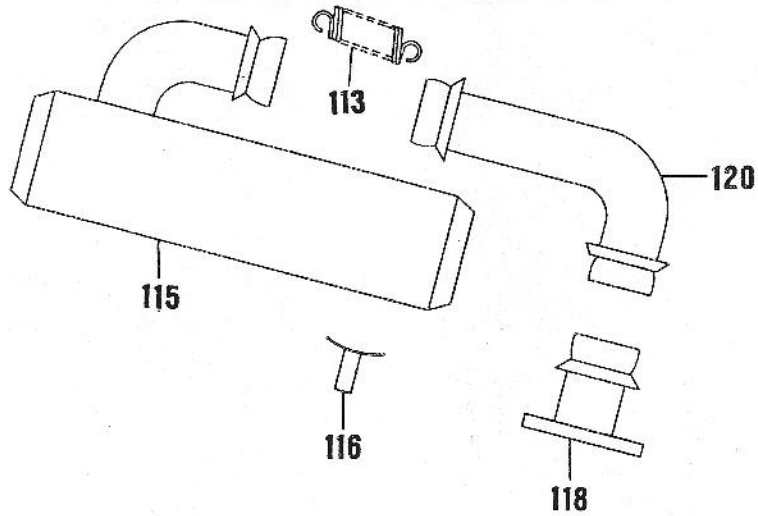

430 ULII - 02 STANDARD EXHAUST KIT

KIT NO. 166

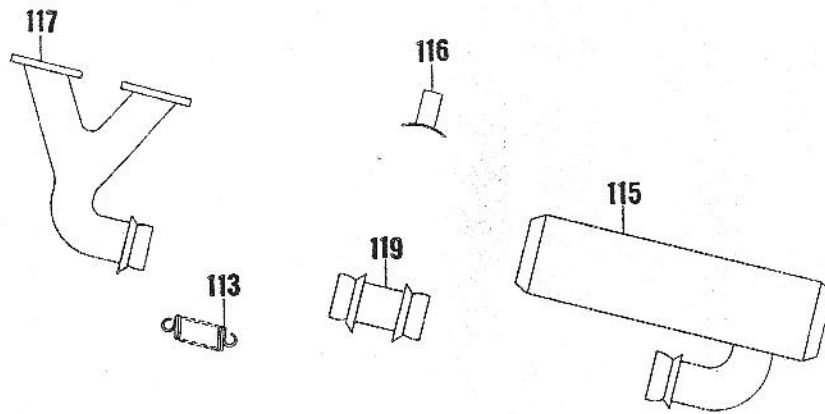

430 HIGH PERFORMANCE EXHAUST KIT

KIT NO. 167

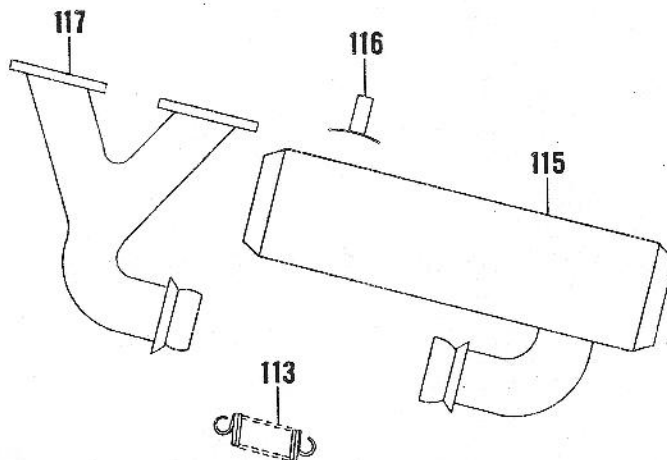

CARBURETORS

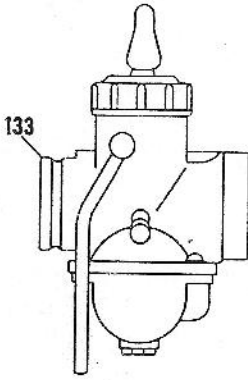

REF. NUMBERS REFER TO PART NUMBERS OF STANDARD VM-28 USED ON 215 & 340 ENGINES.

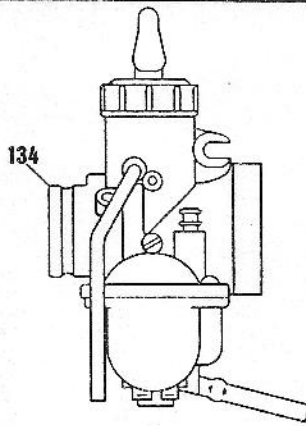

REF. NUMBERS REFER TO PART NUMBER OF STANDARD VM-32 USED ON 430 & ULII-02 ENGINES.

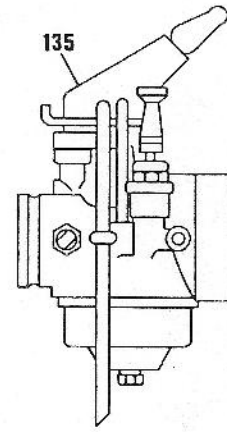

REF. NUMBERS REFER TO THE PART NUMBERS OF THE B-34 USED ON THE 215 AND ON THE HIGH PERFORMANCE APPLICATION.

NOTE: CARBURETOR REFERENCE NUMBERS REFER TO CARBURETORS JETTED FOR USE WITH THE CUYUNA EXHAUST SYSTEM, UNIFILTER FOAM AIR FILTER, AND A PULSE ACTIVATED FUEL PUMP. IF DIFFERENT JETTING IS REQUIRED, CONTACT CUYUNA SERVICE DEPARTMENT DRIVE SYSTEMS, EXHAUST SYSTEMS, AND FUEL SYSTEM WILL AFFECT CARBURETOR CALIBRATION. SPECIFY APPLICATION WHEN ORDERING.

CARBURETOR ATTACHMENTS

28 MM ADAPTER

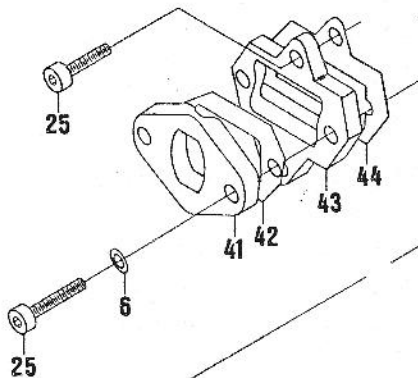

32 MM ADAPTER

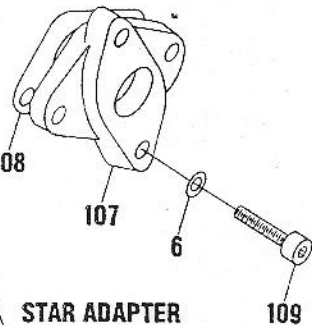
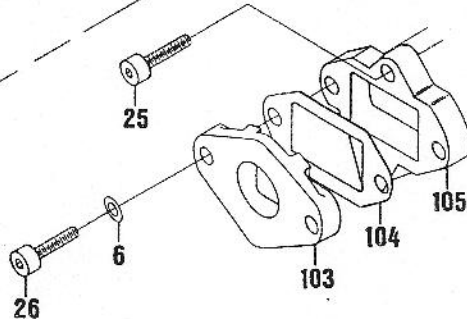

CARBURETOR ATTACHMENTS

138 AIR FILTER

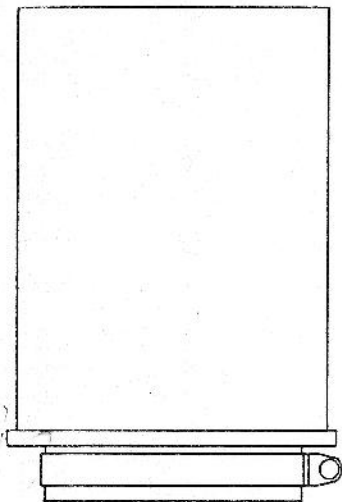

163 SCREW



160 SWIVEL



161 FUEL LINE CLAMP



140 CABLE ENRICHENER VALVE



159 WYE

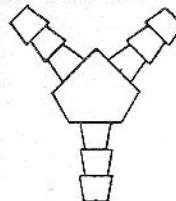

162 FUEL LINE

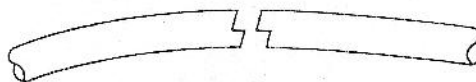

CARBURETOR ATTACHMENTS

139 RUBBER FLANGE

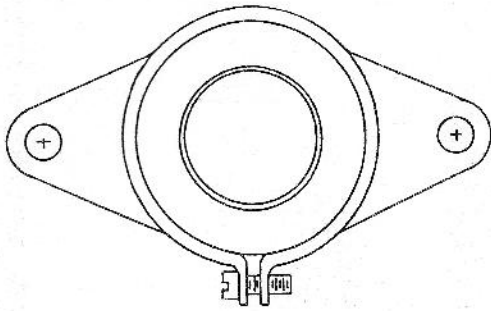

125 FUEL PUMP

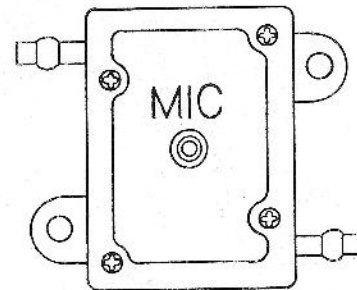

141 BUTTON ENRICHENER VALVE

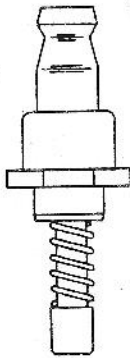

126 THROTTLE JUNCTION, TWO INTO ONE



110 FLYWHEEL PULLER

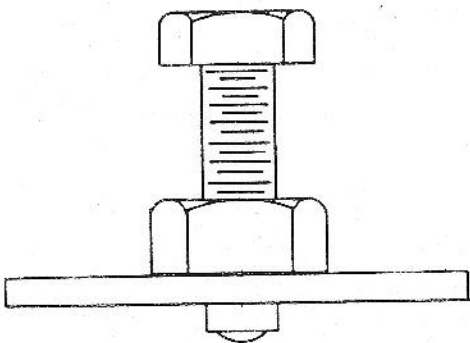

TOOLS

111 RING GEAR TOOL

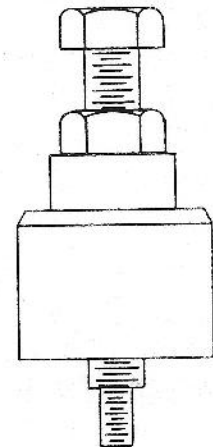

112 WRIST PIN PULLER



ACCESSORIES

50/1
OIL
121

OWNER'S
MANUAL
127

132
PARTS
MANUAL

128
ELECTRICAL
SYSTEM
THEORY

129
SERVICE
MANUAL

130
ENGINE
THEORY

131
FUEL
SYSTEM
THEORY

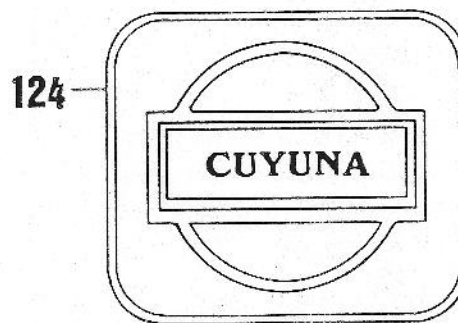
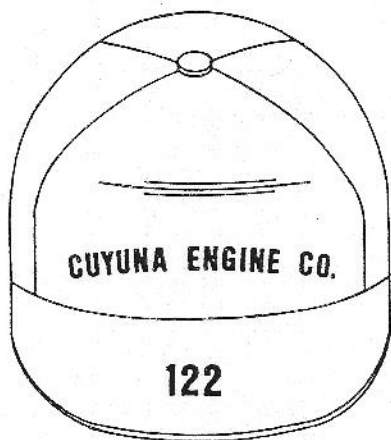

PARTS LISTING

Ref No.	Part Number	Description	ULII-02				
			215	340	430	Std	S.S.
1	000-39-061-680	Bearing, Ball	1	1	1	1	1
2	000-39-071-130	Bearing, Ball	2	2	2	2	2
3	000-39-075-230	Bearing, Ball	1	1	1	1	1
4	000-39-112-730	Bearing, Needle (Note: When replacing, replace wrist pin)	1	2	2	2	2
5	000-40-423-060	Washer, wavie B6 ZP	9	9	9	9	-
	000-40-422-060	Washer, wavie B6 SS	-	-	-	-	9
6	000-40-422-090	Washer, wavie B8 ZP	8	14	18	18	-
	000-40-423-080	Washer, wavie B8 SS	-	-	-	-	18
7	000-40-477-350	Nilos ring	2	2	2	2	2
8	000-40-510-060	Washer, flat A5.3 ZP	2	2	2	2	2
9	000-40-510-090	Washer, flat A8.4 ZP	6	-	12	12	-
	000-40-510-100	Washer, flat A10.5 ZP	-	8	-	-	-
	000-40-510-110	Washer, flat A8.4 SS	-	-	-	-	12
10	000-40-614-320	Ring, locking	2	2	2	2	2
11	000-40-621-420	Circlip	2	4	4	4	4
12	000-40-644-050	Washer, splitlock B5 SS	-	-	-	-	2
	000-40-645-050	Washer, splitlock B5 ZP	4	4	4	4	2
13	002-51-004-000	Decal, ULII-02	-	-	-	2	2
14	000-40-644-060	Washer, splitlock B6 SS	-	-	-	-	3
	000-40-645-060	Washer, splitlock B6 ZP	3	3	3	3	-
15	000-40-644-100	Washer, splitlock B10 SS	-	-	-	-	1
	000-40-645-100	Washer, splitlock B10 ZP	1	1	1	1	-
16	000-40-645-200	Washer, splitlock B20 ZP	1	1	1	1	1
17	000-40-896-150	Key, flywheel	1	1	1	1	1
18	000-41-750-300	SHCS M6x16 ZP	7	7	7	7	3
	000-41-650-060	SHCS M6x16 SS	-	-	-	-	4
19	000-41-270-890	Stud, exh/int M8x20 ZP	4	2	6	6	-
	000-41-272-080	Stud, exh/int M8x20 SS	-	-	-	-	6
20	000-41-240-540	Stud, head M8x95 ZP	6	-	8	8	-
	000-41-273-080	Stud, head M8x95 SS	-	-	-	-	8
	000-41-242-850	Stud, head M10x75 ZP	-	8	-	-	-
	000-41-274-080	Stud, head M8x108 SS	-	-	-	-	4
	000-41-633-080	Stud, head M8x108 ZP	-	-	4	4	-
21	000-41-243-600	Stud, base M8x114 ZP	4	8	8	8	-
	000-41-275-080	Stud, base M8x114 SS	-	-	-	-	8
22	000-41-270-980	Stud, intake M8x76 ZP	-	-	4	4	-
	000-41-276-080	Stud, intake M8x76 SS	-	-	-	-	4
23	000-41-470-000	Plug, crankcase	-	3	3	3	3
24	000-41-501-160	Screw, fillister head ZP	4	4	4	4	2
	000-41-501-050	Screw, fillister head SS	-	-	-	-	2
25	000-41-613-080	SHCS, M8x30	4	-	4	-	-
	000-41-653-080	SHCS, M8X30 SS	4	-	4	-	-
26	000-41-641-080	SHCS, M8x45	-	-	4	-	-
27	000-41-952-020	Nut, hex M10 ZP	1	1	1	1	1
28	000-41-955-070	Nut, hex M20 ZP	1	1	1	1	1
29	000-41-970-100	Nut, hex M8 ZP	8	14	18	18	-
	000-41-970-110	Nut, hex M10 ZP	-	8	-	-	-
	000-41-971-080	Nut, hex M8 SS	-	-	-	-	18
30	000-42-154-320	Ring set, piston std (2/set)	1	-	2	2	2
	000-42-155-000	Ring set, piston O/S (2/set)	1	-	2	2	2

PARTS LISTING

Ref No.	Part Number	Description	ULII-02				
			215	340	430	Std	S.S.
	000-42-153-750	Ring set, piston 340 (2/set)	-	2	-	-	-
32	000-42-175-070	V-belt	1	1	1	1	1
33	000-42-315-480	Seal, oil (Mag)	1	1	1	1	1
34	000-42-315-780	Seal, oil (Pto)	1	1	1	1	1
35	002-44-202-000	Spark plug NGK BR8ES	1	2	2	2	2
	002-44-201-000	Spark plug RN3C	1	2	2	2	2
36	002-44-443-000	Connector CDI	1	2	2	2	2
37	002-44-450-010	Grommet	1	1	1	1	1
38	000-43-221-000	Reg/rectifier LR 21	1	1	1	1	1
39	002-52-666-000	"O"-Ring	1	1	1	1	1
40	215-14-937-000	CDI fan housing ASM RR ND.	1	1	1	1	1
	215-14-938-000	CDI fan housing ASM RF ND.	1	1	1	1	1
	215-14-939-000	CDI fan housing ASM RR KD.	1	1	1	1	1
	215-14-940-000	CDI fan housing ASM RF KD.	1	1	1	1	1
		NOTE: Fan housing includes spacer, bearings, locking rings, and seal installed.					
41	215-07-217-000	Adapter, carburetor (28mm)	1	-	-	-	-
42	215-07-220-000	Gasket, adapter	1	-	-	-	-
43	215-07-218-000	Adapter, carburetor	1	-	-	-	-
44	215-07-219-000	Gasket, adapter	1	-	-	-	-
45	215-07-821-000	Cylinder ASM, 215	1	-	-	-	-
	338-07-821-000	Cylinder, ASM, 340	-	2	-	-	-
	430-07-830-000	Cylinder, ASM, 430	-	-	2	-	-
	430-07-831-000	Cylinder ASM, ULII-02	-	-	-	2	2
		NOTE: Cyl. ASM. includes; cylinder, studs & welch plugs.					
46	291-01-001-000	Nipple, impulse	1	1	1	1	1
47	215-01-863-000	Crankcase 215 RR option	1	-	-	-	-
	291-01-809-000	Crankcase 430 twin RR option	-	-	1	-	-
	291-01-810-000	Crankcase ULII-02 RR option	-	1	-	1	1
48	291-07-401-000	Plug, welch	2	4	4	4	4
49	291-14-003-000	Wheel, fan, standard	1	1	1	1	1
	215-14-221-000	Wheel, fan, rev-flow	1	1	1	1	1
50	215-14-228-000	Carrier, NSI recoil	1	1	1	1	1
51	215-41-822-000	Recoil, NSI	1	1	1	1	1
52	215-86-901-000	Crankshaft ASM 215	1	-	-	-	-
	291-03-817-000	Crankshaft ASM w/Bearings	-	1	1	1	1
		NOTE: Includes; crankshaft asm, needle bearings, check plates, & ball bearings (pto&mag)					
53	338-03-007-000	Washer, thrust	1	1	1	1	1
54	338-03-013-000	Plate, check	2	4	4	4	4
55	338-05-002-000	Pin, wrist	1	2	2	2	2
		NOTE: When ordering, order new bearing.					
56	000-43-811-000	Coil, ignition (twin) KD	-	1	1	1	1
(21)	000-43- 205 -000	Coil, ignition (twin) ND	-	1	1	1	1
	000-43-816-000	Coil, ignition (single) KD	1	-	-	-	-
	000-43-210-000	Coil, ignition (single) ND	1	-	-	-	-
57	000-43-808-000	Amplifier, CDI KD	1	1	1	1	1
	000-43-201-000	Amplifier, CDI ND	1	1	1	1	1
58	000-43-815-000	Magneto ASM, CDI KD	1	1	1	1	1
	000-43-203-000	Magneto ASM, CDI ND	1	1	1	1	1
59	000-43-806-000	Stator, ASM, CDI KD	1	1	1	1	1
	000-43-205-000	Stator ASM, CDI ND	1	1	1	1	1
60	000-43-813-000	Flywheel ASM, CDI KD	1	1	1	1	1
	000-43-204-000	Flywheel ASM, CDI ND	1	1	1	1	1

PARTS LISTING

Ref	Part Number	Description	215	340	430	ULII-02 Std	S.S.
61	338-07-008-020	Gasket, base	1	2	2	2	2
62	338-14-007-020	Shaft	1	1	1	1	1
63	338-14-008-000	Spacer	1	1	1	1	1
64	338-14-009-000	Washer, clamping	2	2	2	2	2
65	338-14-012-000	Spacer	6	6	6	6	6
66	399-07-008-000	Gasket, exhaust	1	-	2	2	2
67	215-07-011-000	Gasket, intake ULII-02	-	-	-	4	4
	399-07-011-000	Gasket, intake 430-215	2	-	4	-	-
	338-07-011-010	Gasket, intake 340	-	4	-	-	-
68	215-07-012-000	Block, insulator ULII-02	-	-	-	2	2
	399-07-012-000	Block, insulator 430-215	1	-	2	-	-
	338-07-041-000	Block, insulator 340	-	2	-	-	-
69	430-07-841-000	Manifold,intake ULII-02(paint)	-	-	-	-	1
	399-07-841-000	Manifold,intake 430	-	-	1	-	-
	338-07-043-000	Manifold,intake 340	-	1	-	-	-
70	399-14-002-000	Pulley, top half	2	2	2	2	2
71	438-05-818-000	Piston, STD	1	-	2	2	2
	438-05-819-000	Piston, oversize .5mm	1	-	2	2	2
	338-05-808-010	Piston, STD 340	-	2	-	-	-
	438-05-915-000	Piston ASM, STD	1	-	2	2	2
	215-05-916-000	Piston ASM, Oversize .5mm	1	-	2	2	2
	338-05-906-000	Piston ASM, 340	-	2	-	-	-
		NOTE: Includes piston rings circlips,and wrist pin. (When ordering, replace wrist pin)					
72	438-07-014-000	Gasket, head	1	-	2	2	2
	338-07-007-010	Gasket, head 340	-	2	-	-	-
73	438-07-016-000	Head, flow thru	-	-	1	1	1
	438-07-015-000	Head, STD	1	-	1	1	1
	338-07-063-000	Head, STD 340	-	2	-	-	-
74	215-14-223-000	Pulley half, NSI	2	2	2	2	2
75	000-41-972-060	Nut, hex 6M SS	1	1	1	1	1
76	000-41-596-060	HHCS, M6x25 SS	-	-	-	-	1
	000-41-630-060	HHCS, M6x25 ZP	1	1	1	1	-
77	000-41-594-060	HHCS, M6x20 SS	-	-	-	-	3
	000-41-590-060	HHCS, M6x20 ZP	3	3	3	3	-
78	002-44-153-000	Bracket, Coil mount SS	1	1	1	1	1
79	000-41-605-080	Nut, acorn (Closed end)	-	-	-	6	-
80	000-41-606-080	Nut, acorn (Open end)	-	-	-	6	-
81	215-31-905-000	Guard, Fan kit-STD	1	1	1	1	1
82	215-14-405-000	Guard, fan STD	1	1	1	1	1
83	002-43-001-000	Ny-drive	1	1	1	1	1
84	000-45-203-000	Screw,#6 x 1/2"	2	2	2	2	2
85	002-51-005-000	Decal, recoil	1	1	1	1	1
86	000-43-413-000	Tie, wire	1	1	1	1	1
87	002-44-533-000	Terminal,male,push on	3	3	3	3	3
89	000-41-616-080	Screw, flat head-CDI(KD)	4	4	4	4	4
	002-43-003-000	Screw, flat head-CDI(ND)	4	4	4	4	4
90	002-44-141-000	Bar, grounding(single cyl.)	1	-	-	-	-
91	002-44-129-000	Retainer,wire(service parts)	-	-	-	-	-
92	291-11-801-000	Gear, ring (Elect. start)	1	1	1	1	1
93	338-11-011-000	Bracket, front(Elect. start)	1	1	1	1	1
94	000-42-319-450	Seal, oil (Elect. Start)	1	1	1	1	1
95	000-41-651-060	SHCS, M6x14 SS (Elect. start)	1	1	1	1	1
96	000-41-652-060	SHCS, M6x20 SS (Elect. start)	1	1	1	1	1
97	000-41-653-080	SHCS, M8x30 SS (Elect. start)	2	2	2	2	2
98	000-40-644-080	Washer, Splitlock M8 SS	3	3	3	3	3
99	002-53-033-000	Motor, starter(Elect.start)	1	1	1	1	1

PARTS LISTING

Ref No.	Part Number	Description	ULII-02				
			215	340	430	Std	S.S.
100	002-53-034-000	Bracket, rear (Elec. start)	1	1	1	1	1
101	002-53-035-000	Solenoid, (Elec. start)	1	1	1	1	1
102	000-41-655-080	HHCS, M8x16 SS (Elec. start)	1	1	1	1	1
103	215-07-224-000	Adapter, carburetor	1	-	2	-	-
104	215-07-226-000	Gasket, adapter	1	-	2	-	-
105	215-07-223-000	Adapter, carburetor	1	-	2	-	-
106	291-31-910-000	Kit, electric start	1	1	1	1	1
107	291-07-307-000	Adapter, carb. (28mm-star)					
108	291-07-308-000	Gasket, adapter (28mm-star)					
109	000-41-741-280	SHHCS, M8x25 (Star adapter)					
110	444-31-844-000	Puller, flywheel					
111	444-31-886-000	Tool, ring gear					
112	444-31-805-000	Puller, wrist pin					
113	215-29-006-000	Spring, Short, ball joint					
114	215-29-007-000	Spring, long, ball joint					
115	215-29-018-000	Muffler, standard					
116	430-29-676-000	Pipe, tail (exhaust)					
117	430-29-641-000	Manifold, exhaust, twin	-	-	1	1	1
	338-07-050-000	Manifold, exhaust, 340	-	1	-	-	-
118	215-29-001-000	Manifold, exhaust, 215	1	-	-	-	-
119	430-29-643-000	Pipe, intermediate, twin	-	-	-	1	1
120	215-29-002-000	Pipe, intermediate, single	1	-	-	-	-
121	000-44-001-000	Oil, Cuyuna 50:1					
122	000-01-004-000	Cap, Cuyuna					
124	002-51-002-000	Decal, Cuyuna logo					
	002-51-010-000	Patch, Cuyuna logo					
125	002-45-433-000	Pump, fuel, Mikuni					
	002-45-389-000	Pump, fuel, DF52-21			1		
126	002-45-478-000	Junction, throttle, with cable, (2 into 1)					
127	002-95-104-000	Manual, Owners A/C	1	1	1	1	1
128	002-94-103-000	Manual, Elec Syst Theory					
129	002-95-105-000	Manual, Service					
130	002-94-101-000	Manual, Engine Theory					
131	002-94-102-000	Manual, Fuel Syst Theory					
132	002-95-101-000	Manual, Parts					
133	215-19-002-000	Carburetor, VM-28 215	1	-	-	-	-
	338-19-652-000	Carburetor, VM-28 340	-	1	-	-	-
134	430-19-653-000	Carburetor, 430-H.P.	-	-	2	-	-
	430-19-652-000	Carburetor, VM-32 ULII-02	-	-	-	1	1
	430-19-641-000	Carburetor, VM-32 430	-	-	1	-	-
	215-19-011-000	Carburetor, VM-32 215	1	-	-	-	-
135	430-19-646-000	Carb, B34/32 Butterfly, HP	-	-	2	-	-
	215-19-001-000	Carb, B34/32 Butterfly, 215	1	-	-	-	-
138	002-45-402-000	Filter, air 28mm	1	1	-	-	-
	002-45-407-000	Filter, air B-34 (Butterfly)	1	-	2	-	-
	002-45-420-000	Filter, air ULII-02	-	-	-	1	1
139	002-45-410-000	Flange, rubber 28mm	1	1	-	-	-
	002-45-409-000	Flange, rubber 32mm	1	-	2	1	1
140	002-45-400-000	Valve, cable enrichener					
141	002-45-399-000	Valve, button enrichener					
142	000-45-210-000	Nut, hex lock 5/16"	-	-	2	2	2
143	430-31-345-000	Bracket, muffler, steel	-	-	2	2	2
		(NOTE: When ordering mounting kit, Cuyuna will weld bracket (ref. 158) to muffler.					
145	002-49-008-000	Bushing, rubber, male	-	-	2	2	2
146	430-31-344-000	Bracket, muffler mount	-	-	1	1	1

PARTS LISTING

Ref No.	Part Number	Description	ULII-02				
			215	340	430	Std	S.S.
147	002-49-007-000	Bushing, rubber, female	-	-	2	2	2
148	000-46-107-000	Washer, fendor 5/16"	-	-	2	2	2
149	000-41-640-031	HHCS, 5/16"	-	-	2	2	2
150	000-45-209-000	Nut, hex 1/4"	-	-	2	2	2
151	000-46-108-000	Washer, flat 5/16"	-	-	2	2	2
152	000-41-639-025	HHCS, 1/4"	-	-	2	2	2
153	430-31-342-000	Bracket, cylinder, L.H.	-	-	1	1	1
	430-31-341-000	Bracket, cylinder, L.H. (Long)	-	-	1	1	1
154	000-46-106-000	Washer, flat, 1/4"	-	-	4	4	4
155	430-31-343-000	Bracket, cylinder, R.H.	-	-	1	1	1
	430-31-340-000	Bracket, cylinder, R.H. (Long)	-	-	1	1	1
157	000-41-633-080	Stud, Head M8 (Long)	-	-	4	4	4
158	430-51-305-000	Mount, muffler (As shown)	-	-	1	1	1
	430-51-307-000	Mount, muffler NOTE: When ordering mounting kit, Cuyuna will weld bracket (Ref. #143) to muffler.	-	-	1	1	1
159	002-45-418-000	Wye, fuel	-	-	1	-	-
160	000-53-001-000	Swivel	-	-	2	-	-
161	002-49-003-000	Clamps, fuel line	-	-	13	-	-
162	002-45-398-000	Line, fuel 30"	-	-	1	-	-
163	000-41-638-050	HHCS, (Swivel)	-	-	2	-	-
164	215-31-917-000	Carb-exhaust 215 Butterfly	1	-	-	-	-
165	215-31-932-000	Kit, Exhaust 215	1	-	-	-	-
166	430-31-370-000	Kit, Exhaust ULII-02/430	-	-	1	1	1
167	430-31-376-000	Kit, Exhaust 430 H.P.	-	-	1	-	-
168	430-31-333-000	Kit, Carb-exhaust 430 H.P.	-	-	1	-	-
	430-31-366-000	Kit, Carb-Exh (Butterfly HP)	-	-	1	-	-
169	430-31-351-000	Kit, Carb-exhaust 430 STD. with VM-32 Mikuni	-	-	1	-	-
170	430-31-339-000	Kit, carburetor, ULII-02	-	-	-	1	1
171	430-31-338-000	Kit, carburetor STD. 430	-	-	1	-	-
172	430-31-379-000	Kit, carb, 430 HP VM-32	-	-	1	-	-
173	215-61-901-000	Gasket set, 215 complete	1	-	-	-	-
174	430-61-902-000	Gasket set, 430 H.P. Complete	-	-	1	-	-
175	430-61-903-000	Gasket set, 430 STD. Complete	-	-	1	-	-
176	430-61-905-000	Gasket set, ULII-02 Complete	-	-	-	1	1
177	338-07-030-000	Gasket set, 340 Complete	-	1	-	-	-
178	430-31-384-000	Kit, Carb-exhaust STD. ULII-02 with VM-32 Mikuni	-	-	-	1	1
179	215-31-907-000	Kit, carb. STD 215 32mm	1	-	-	-	-
180	215-31-916-000	Kit, carb 215 28mm	1	-	-	-	-
181	338-19-655-000	Kit, carb 340 28mm	-	1	-	-	-
182	338-07-055-000	Kit, exhaust 340	-	1	-	-	-
183	338-07-060-000	Kit, Carb-Exh 340	-	1	-	-	-

STANDARD CARBURETOR AND EXHAUST

KIT NO. 169
430 STANDARD

REF.NO.	REF.NO.	DESCRIPTION	QTY
166	116	Pipe, tail	1
	113	Spring	6
	115	Muffler	1
	117	Manifold, exhaust	1
	119	Pipe, intermediate	1
171	134	Carburetor	1
	125	Pump, fuel	1
	138	Filter	1
	139	Flange, rubber	1

STANDARD CARBURETOR AND EXHAUST

KIT NO. 168
430 HP

REF.NO.	REF.NO.	DESCRIPTION	QTY.
167	116	Pipe, tail	1
	117	Manifold, exhaust	1
	113	Spring	3
	115	Muffler	1
172	138	Filter	2
	134	Carburetor	2
	139	Flange, rubber	2
	103	Adapter, carb.	2
	105	Adapter, carb.	2
	104	Gasket	2
	25	Screw	4
	26	Screw	4
	6	Washer	4
	67	Gasket, intake	4
	68	Insulator block	2
	125	Pump, fuel	2
	159	Wye	1
	66	Gasket, exhaust	2
	160	Swivel	2
	161	Clamp, fuel line	13
	162	Fuel, line 30"	1
	163	Screw, swivel	2
	126	Throttle junction	1
	46	Impulse nipple	1

STANDARD CARBURETOR AND EXHAUST

KIT NO. 164
215 BUTTERFLY

REF.NO.	DESCRIPTION	QTY
REF.NO. 165	119 Exhaust manifold	1
	120 Intermediate pipe	1
	115 Muffler	1
	113 Spring	6
	116 Tail pipe	1
REF.NO. 180	133 Carburetor	1
	125 Fuel pump	1
	138 Filter	1
	139 Flange, rubber	1
	6 Washer	2
	25 Screw	4
	41 Adapter, carb	1
	43 Adapter, carb	1
	42 Gasket	1
	44 Gasket	1

STANDARD CARBURETOR AND EXHAUST

KIT NO. 178
ULII-02 WITH VM-32 MIKUNI

REF.NO.	DESCRIPTION	QTY
REF.NO. 166	113 Spring	6
	115 Muffler	1
	119 Intermediate pipe	1
	117 Manifold, exhaust	1
	116 Pipe, tail	1
REF.NO. 170	139 Flange, rubber	1
	138 Filter, air	1
	125 Pump, fuel	1
	134 Carburetor	1

NO. 174
430 HP COMPLETE GASKET SET

REF.NO.	DESCRIPTION	QTY
72	Gasket, head	2
66	Gasket, exhaust	2
67	Gasket, intake	4
68	Insulator block	2
61	Gasket, base	2
104	Gasket, adapter	2
33	Seal, oil	1
34	Seal, oil	1
39	O-Ring	1

NO. 175
430 STD. COMPLETE GASKET SET

REF.NO.	DESCRIPTION	QTY
72	Gasket, head	2
66	Gasket, exhaust	2
67	Gasket, intake	4
61	Gasket, base	2
68	Insulator block	2
33	Seal, oil	1
34	Seal, oil	1
39	O-Ring	1

NO. 176
ULII-02 COMPLETE GASKET KIT

REF.NO.	DESCRIPTION	QTY
72	Gasket, head	2
66	Gasket, exhaust	2
67	Gasket, intake	4
61	Gasket, base	2
68	Insulator block	2
33	Seal, oil	1
34	Seal, oil	1
39	O-Ring	1

NO. 177
340 COMPLETE GASKET SET

REF.NO.	DESCRIPTION	QTY
33	Seal, oil	1
34	Seal, oil	1
61	Gasket, base	2
72	Gasket, head	2
39	O-Ring	1
67	Gasket, intake	4
68	Insulator, block	2

APPENDIX

This Cuyuna Parts Manual has been prepared by Cuyuna Service Personnel to aid in ordering of service parts for all Cuyuna Engines manufactured since January 1, 1981.

When ordering certain parts, it may be necessary to specify the model designation of the engine. Crankcases will indicate the model by the letters stamped on the crankcase upper half, near the magneto end on the exhaust side.

CUYUNA ENGINE MODEL DESIGNATIONS For 215, 340, 430, and ULI-02

Engine Model

"RR" Crankcase with PTO face machined and 4-10mm holes drilled and tapped to allow mounting of reduction assembly.

"RF" Designates reverse flow of air through the engine. (Can be used with any model.)

When placing Parts Orders, phone 218/546-8313.

All shipments will be made freight collect unless prior arrangements are made.

Keep this manual in the shop area for reference and training.

CUYUNA ENGINE COMPANY
CUSTOMER SERVICES DEPARTMENT
P.O. BOX 116
CROSBY, MN 56441